

Bar Type Vibration Motor ($\phi 3.2$ Spring Reed Type Vibration Motor)

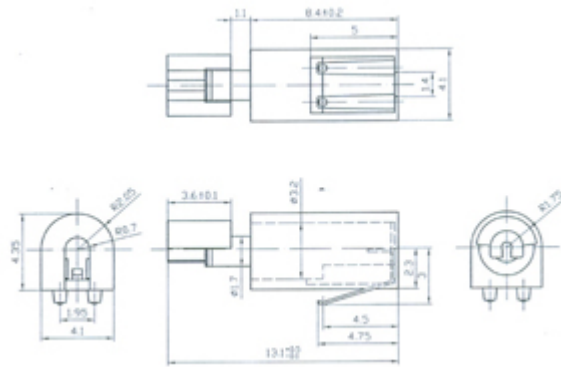

Enlarge

[\$\phi 3.2\$ Spring Reed Type Vibration Motor](#)

Name: $\phi 3.2$ Spring Reed Type Vibration Motor

Model: 3.2HK08-S1

Applications:

- Mobile phone
- PCS (Personal Communication by Satellite)

Specification: Different structures of counterweight and spring reeds are available according to your requirements.

Technical data:

Rated Voltage	Rated Current	Rated Speed	Stall Current	Starting Voltage	Terminal Impedance	Service Voltage
1.3VDC	80mA(Max)	10000±2500	95mA(Max)	1.1V(Max)	13 Ω ±10%	1.0V~ 2.0V
3VDC	75mA(Max)	13000±2000	85mA(Max)	2.5V(Max)	34 Ω ±10%	2.5V~ 3.6V